

# Consider the benefits of using an AeroChamber®

## Inhaler Alone

Many patients do not use their inhaler properly resulting in poor delivery of medication to the lungs.<sup>1</sup>

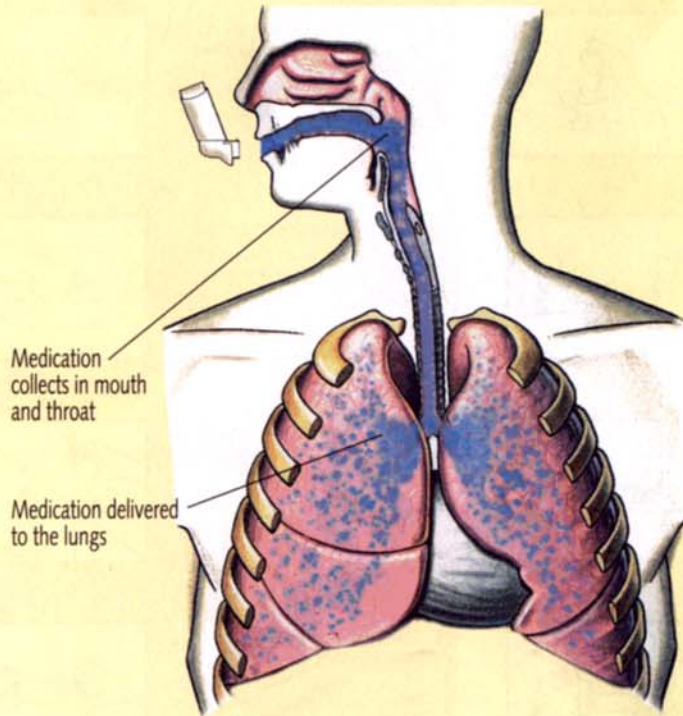

## Inhaler + AeroChamber®

Using an AeroChamber® with an inhaler improves delivery of medication to the lungs and reduces side effects.<sup>1,2</sup>

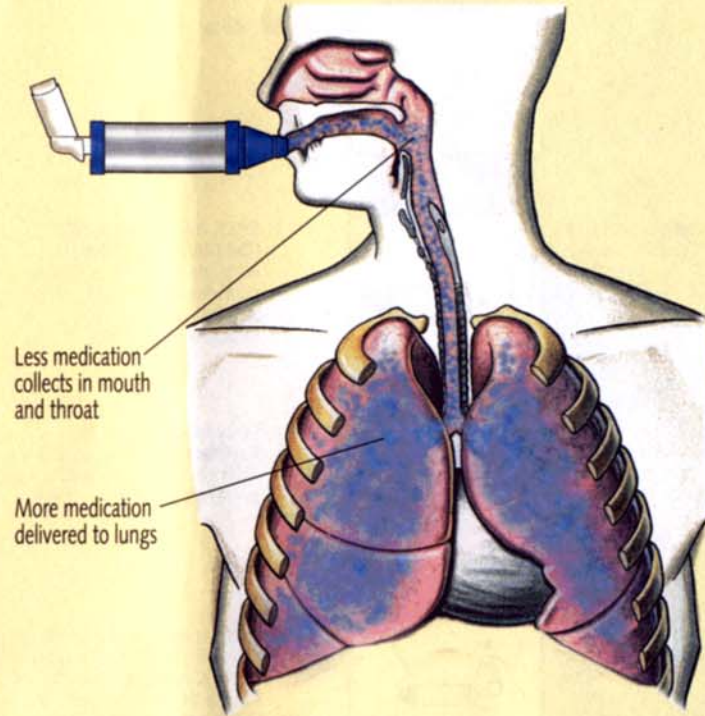

Illustration adapted from Dolovich M. et al.<sup>2</sup>

References: 1. Salzman GA, Pyszczynski DR. Oropharyngeal candidiasis in patients treated with budesonide delivered by metered-dose inhaler alone and with AeroChamber. *J. Allergy Clin. Immunol.* 1988;81:424-428.  
2. Dolovich M. et al. Clinical evaluation of a simple demand inhalation MDI aerosol delivery device. *Chest* 1983;84:36-41.



# AeroChamber®

(Aerosol Holding Chamber With Valve)



 **Boehringer  
Ingelheim**  
Value through innovation



**THE LUNG ASSOCIATION**  
The Lung Association believes that the use of an AeroChamber® with your puffer is helpful in delivering medication to the lungs.

## How to use the AeroChamber® with Mouthpiece

1. Take the plastic cap off the inhaler mouthpiece and the AeroChamber® mouthpiece. CHECK FOR FOREIGN OBJECTS. ENSURE ALL PARTS ARE SECURE.

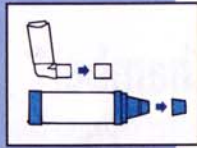

2. Shake the inhaler well.

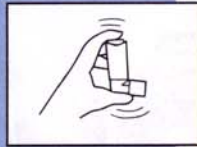

3. Put the inhaler mouthpiece into the large opening of the inhaler adaptor on the AeroChamber®.

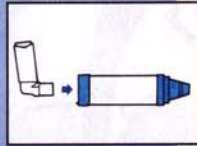

4. Put the mouthpiece of the AeroChamber® into your mouth. Close your lips on the mouthpiece. Do not cover the small slots.

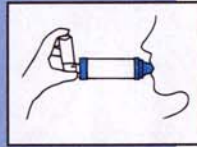

5. Press the metal canister down into the inhaler. This sprays the medication into the AeroChamber®. Make sure that the inhaler mouthpiece and canister are not held on an angle, as this may reduce the medication that reaches you.

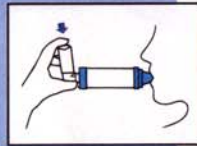

6. Take a slow deep breath. Then, hold this breath for 5 to 10 seconds. IF YOU ARE UNABLE TO TAKE A DEEP BREATH OR IF YOU CAN'T HOLD A DEEP BREATH, breathe in and out normally for 3 or 4 breaths.



7. For each puff of medication needed, repeat steps 2 to 6. Make sure that you wait at least 30 seconds between puffs. Do not spray more than one puff at a time into the AeroChamber®.

8. Remove the inhaler and replace the protective caps after use.

## How to use the AeroChamber® with Mask

1. Take the plastic cap off the inhaler mouthpiece.

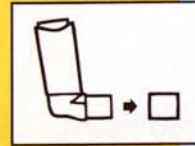

2. Shake the inhaler well.



3. CHECK THE AeroChamber® FOR FOREIGN OBJECTS. ENSURE ALL PARTS ARE SECURE. Put the inhaler mouthpiece into the large opening of the inhaler adaptor on the AeroChamber® with Mask.

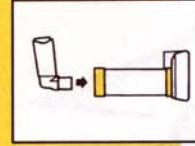

4. Gently place the mask of the AeroChamber® with Mask over the child's mouth and nose so that they are covered and a good seal is obtained.

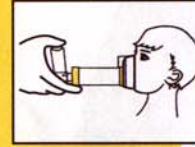

5. Press the metal canister down into the inhaler. This sprays the medication into the AeroChamber® with Mask. Make sure that the inhaler mouthpiece and canister are not held on an angle, as this may reduce the medication that reaches the child.



6. Hold the mask in place for at least 6 breaths. Look inside the chamber and watch to see if the flapper valve is opening and closing with each breath. If the flapper valve is not opening and closing with each breath, try to move the mask until you have a better seal over the child's mouth and nose.



7. For each puff of medication needed, repeat steps 2 to 6. Make sure that you wait at least 30 seconds between puffs. Do not spray more than one puff at a time into the AeroChamber® with Mask.

8. Remove the inhaler and replace the protective cap after use.

## How to clean the AeroChamber®

1. Remove the inhaler adaptor of the AeroChamber®.

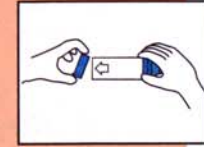

2. Soak the AeroChamber® parts in a basin filled with warm water using a mild detergent and gently agitate to dislodge or loosen any residue. Inspect the inside of the AeroChamber® for cleanliness.



3. Rinse the AeroChamber® parts in a basin filled with warm clear water using a gentle motion. Repeat if necessary.



4. Lightly shake excess water off of the AeroChamber® and leave on a clean surface to air dry overnight.



5. Check that all parts are in place and replace the inhaler adaptor onto the AeroChamber®. Ensure that the AeroChamber® is **completely dry** before use.

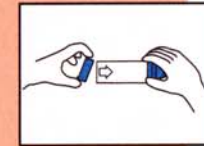

6. Clean your AeroChamber® once a week.

Do not use high pressure water, boiling hot water, alcohol, disinfectants or strong detergents to clean the AeroChamber®. This may damage the valve and the chamber. The AeroChamber® is not dishwasher safe. Never take the flapper valve, mouthpiece or mask of the AeroChamber® apart. These parts may become loose if handled and can endanger the patient during use.

### Care of the AeroChamber®

The AeroChamber® is made up of sensitive parts and should be treated carefully. The AeroChamber® is not a toy. **Keep out of the reach of children when not in use.**

### Replacement

The AeroChamber® may need to be replaced after 12 months of use. Talk to your physician or pharmacist to see if it is time for you to replace it.